

Thermal welding of debolon floor coverings

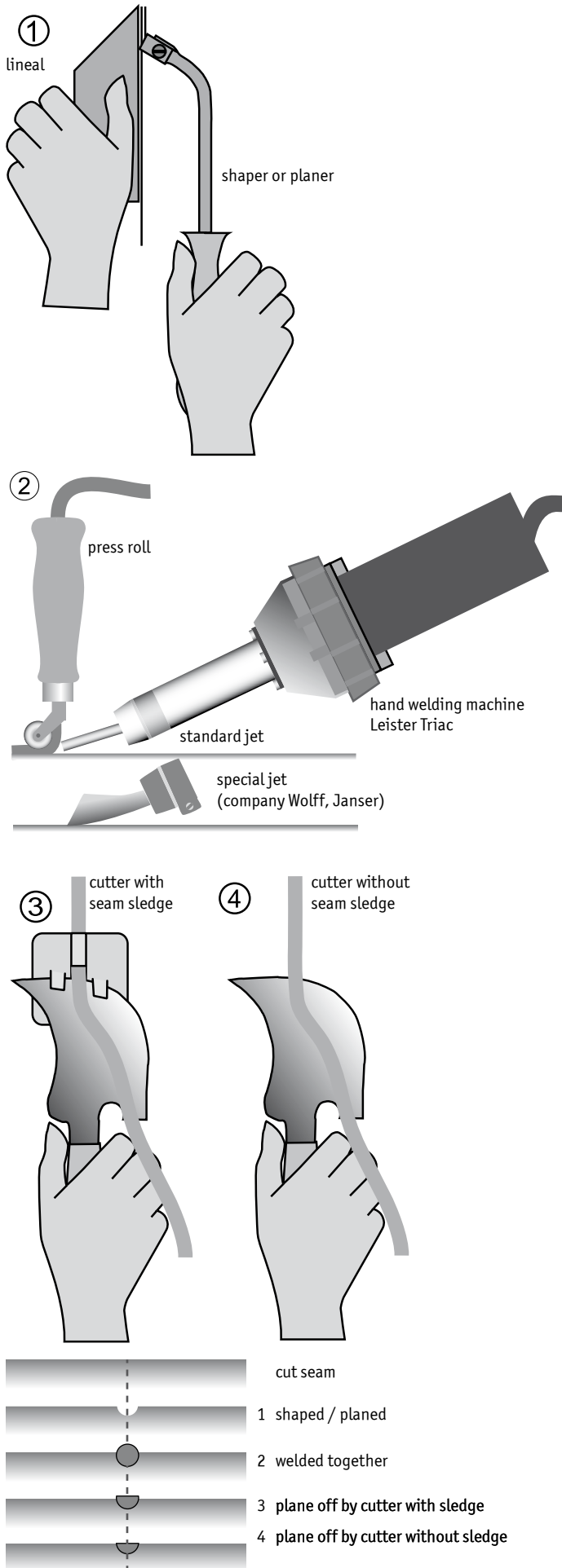

Thermal welding of the debolon products COMPACT XPS®, LIVE SPEZIAL, LIFETEC®SPEZIAL und LIFETEC®COMFORT (heterogeneous and compound floor coverings)

- please note: just 24 hours after installation should be welded
- set the depth of shaper/planer according to the thickness of wear layer, testing at remains of flooring before
- use of original weld rod
- hand welding machine/welding machine is working with a temperature of 400 – 440 °C
- when working with hand welding machine use round jet or special jet with press roll
- a minimal jut out bulge of welding rod shows the optimal welding result
- the jut out welding rod should be planed off step by step:
 1. shape off the still warm bulge by cutter (fitted with sledge) having left a jut out of about 0,6 mm remains
 2. to avoid a hollow seam let cool down the weld rod before completely shaping off the jut out

Please understand these instructions just as recommendation.

However we can not make any guarantees for the success of your work.



debolon dessauer bodenbeläge GmbH & Co.KG
 Ebertallee 209 • 06846 Dessau
 Box 16 02 • 06814 Dessau
 Fon ++49(0)3 40/65 00-0
 Fax ++49(0)3 40/65 00-202
 Internet: www.debolon.de
 e-mail: debolon@debolon.de

19.04.2006